

Elektor Formant

Parts Catalogue



Elektor Formant

A016.20.001
Enclosure Side Assembly

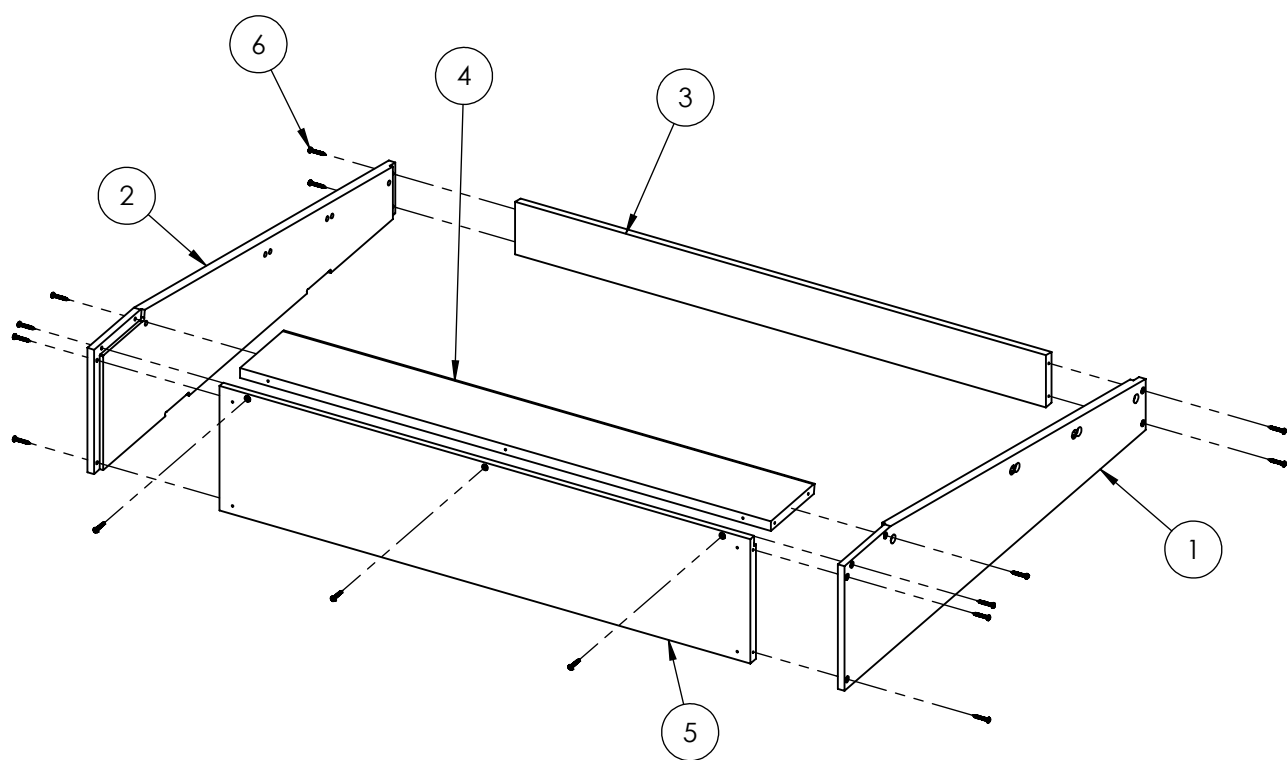

ITEM NO.	PartNo	DESCRIPTION	QTY.
1	A016.02.001	Right side	1
2	A016.02.002	Left Side	1
3	A016.02.003	Top	1
4	A016.02.004	Front	1
5	A016.02.005	Bottom	1
6	002.12.7981.029019	Screw DIN 7981 C 2.9x19	15

Elektor Formant

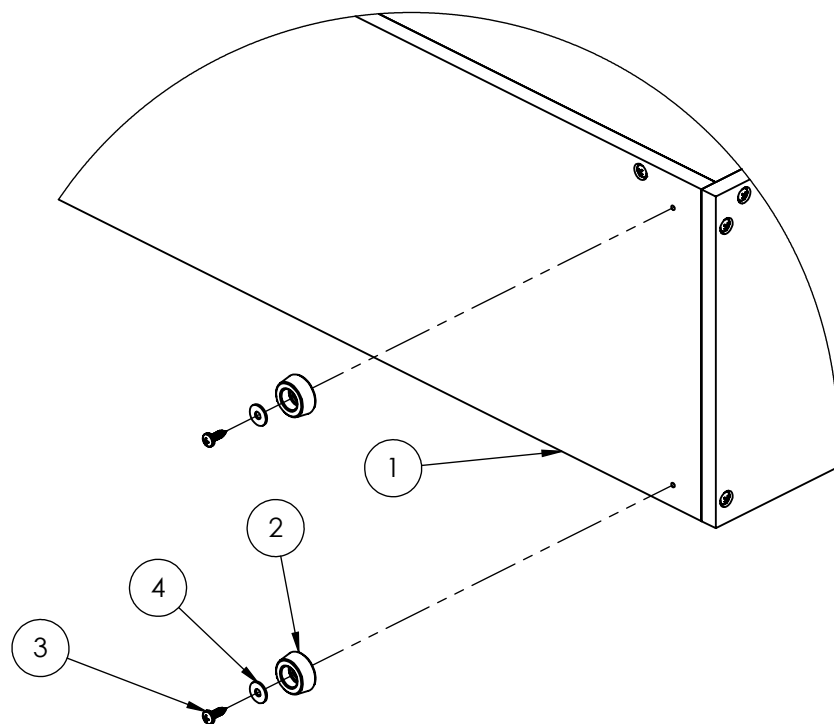
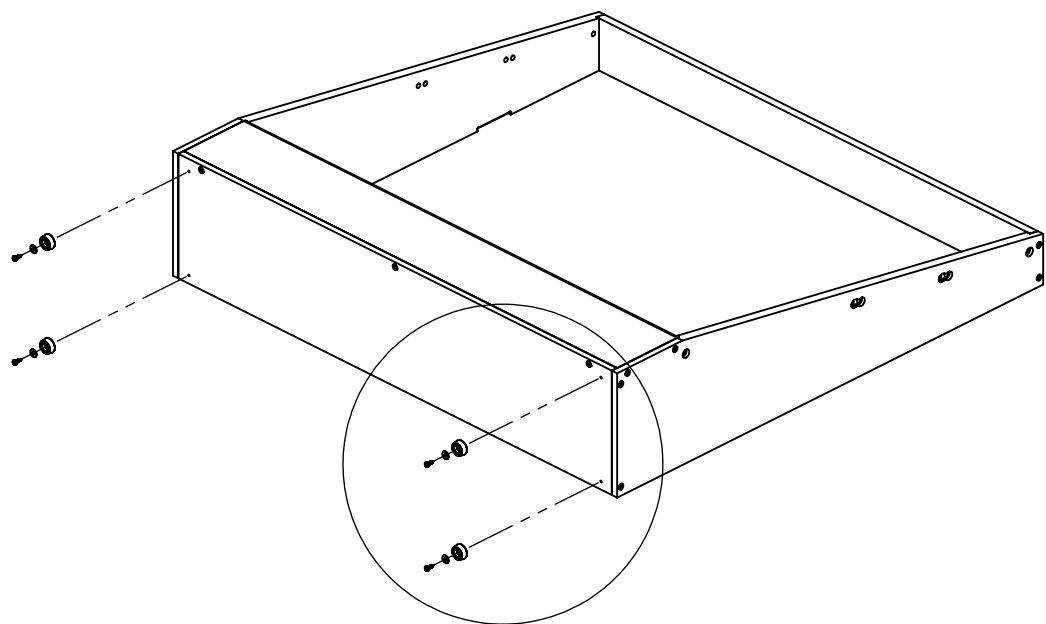

ITEM NO.	PartNo	DESCRIPTION	QTY.
1	A016.20.001	Enclosure Side Assembly	1
2	002.16.1991.1607	Rubber foot	4
3	002.11.7981.029095	Screw DIN 7981 C 2.9x9,5	4
4	002.11.9021.03	Washer DIN 9021-3 (ZP)	4

Elektor Formant

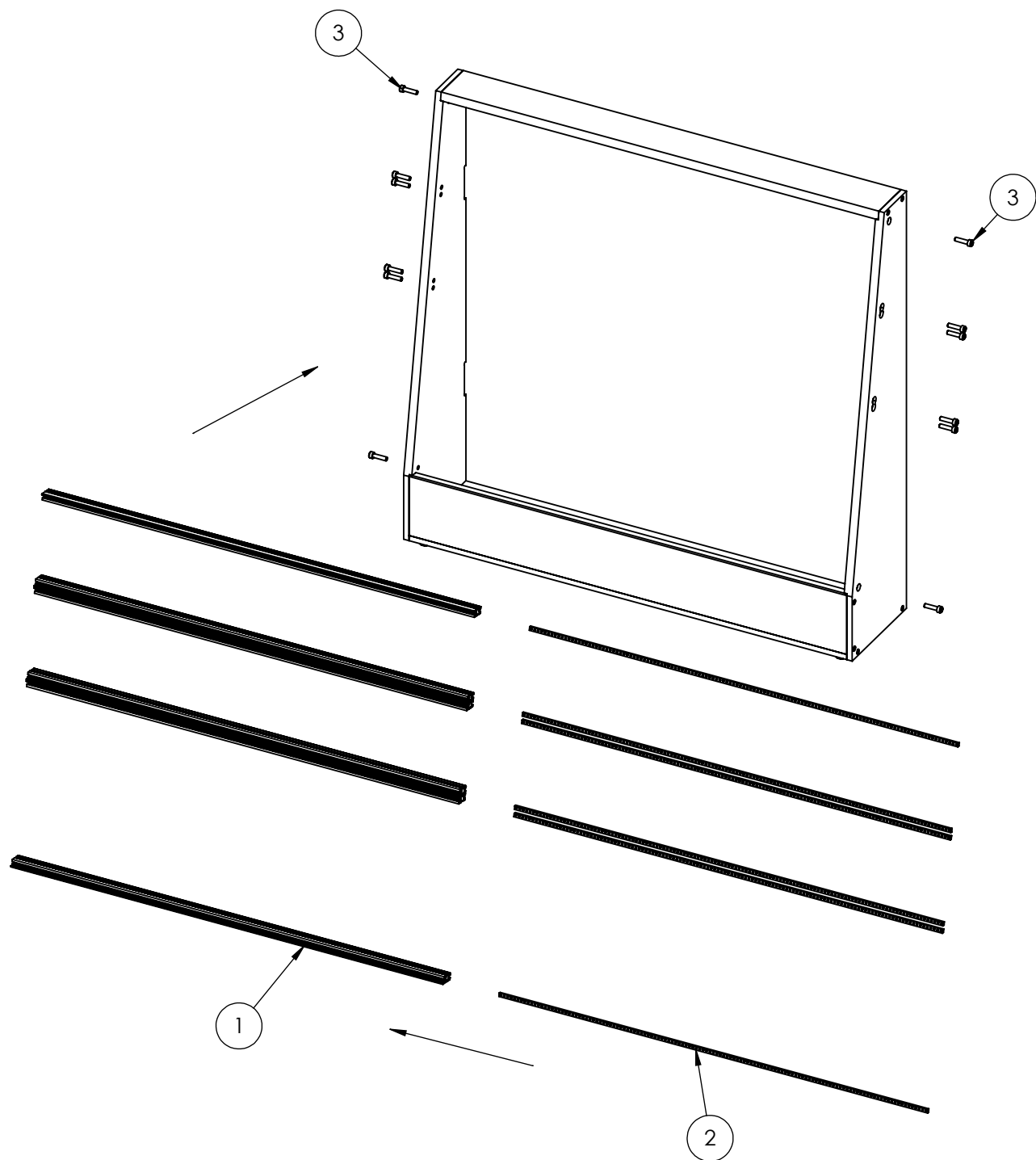

ITEM NO.	PartNo	DESCRIPTION	QTY.
1	A016.02.007	Rail Profile 640mm (black)	6
2	A016.02.008	Rail Profile Insert 635mm 126HP	6
3	002.12.0912.0520	Screw DIN 912 M5x20 (BZP)	12

Elektor Formant

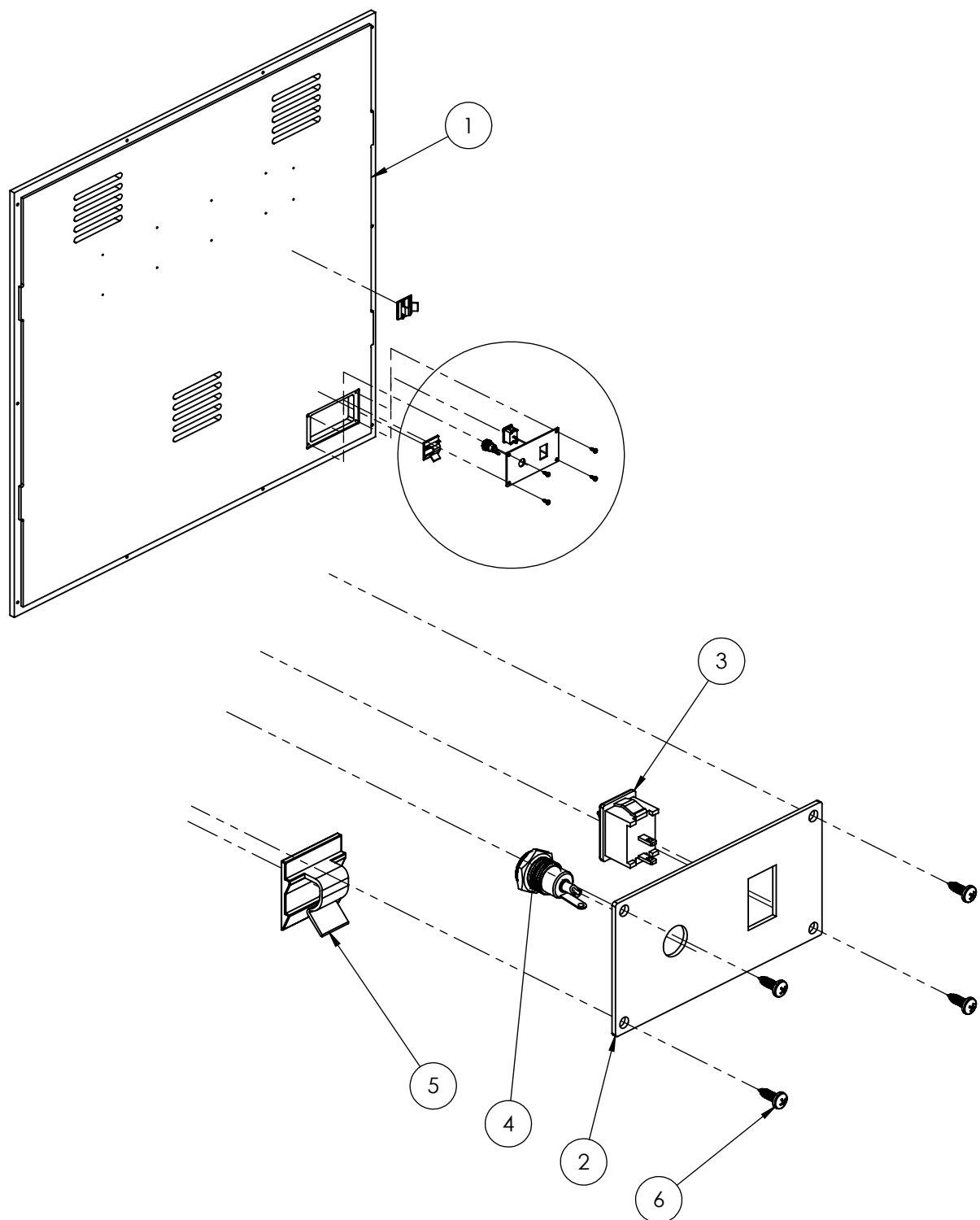

ITEM NO.	PartNo	DESCRIPTION	QTY.
1	A016.02.006	Back	1
2	A016.03.001	Power-In Board	1
3	001.17.18016115	Rocker On/Off Switch SPST	1
4	001.16.PC-GM2.1	DC supply socket - male; 3A 12V; straight; soldering	1
5	002.51.5433-3M	Self-adhesive Cable Holder 26x26	2
6	002.11.7981.029095	Screw DIN 7981 C 2.9x9,5	4

Elektor Formant

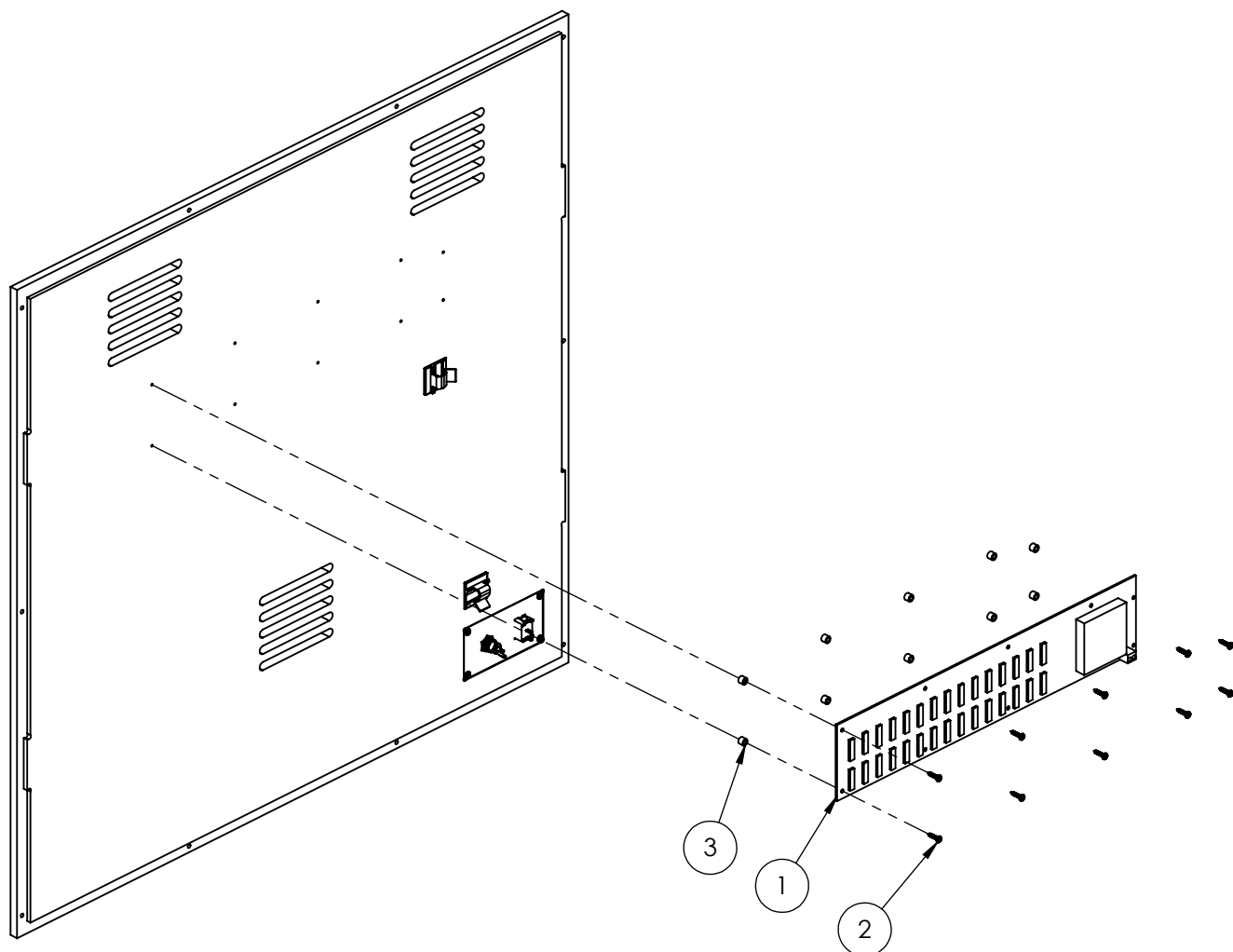

ITEM NO.	PartNo	DESCRIPTION	QTY.
1	A016.03.002	PSU Board	1
2	002.12.7981.029013	Screw DIN 7981 C 2.9x13	10
3	002.51.FIX355	Spacer Sleeve, 3,5x5,0mm	10

Elektor Formant

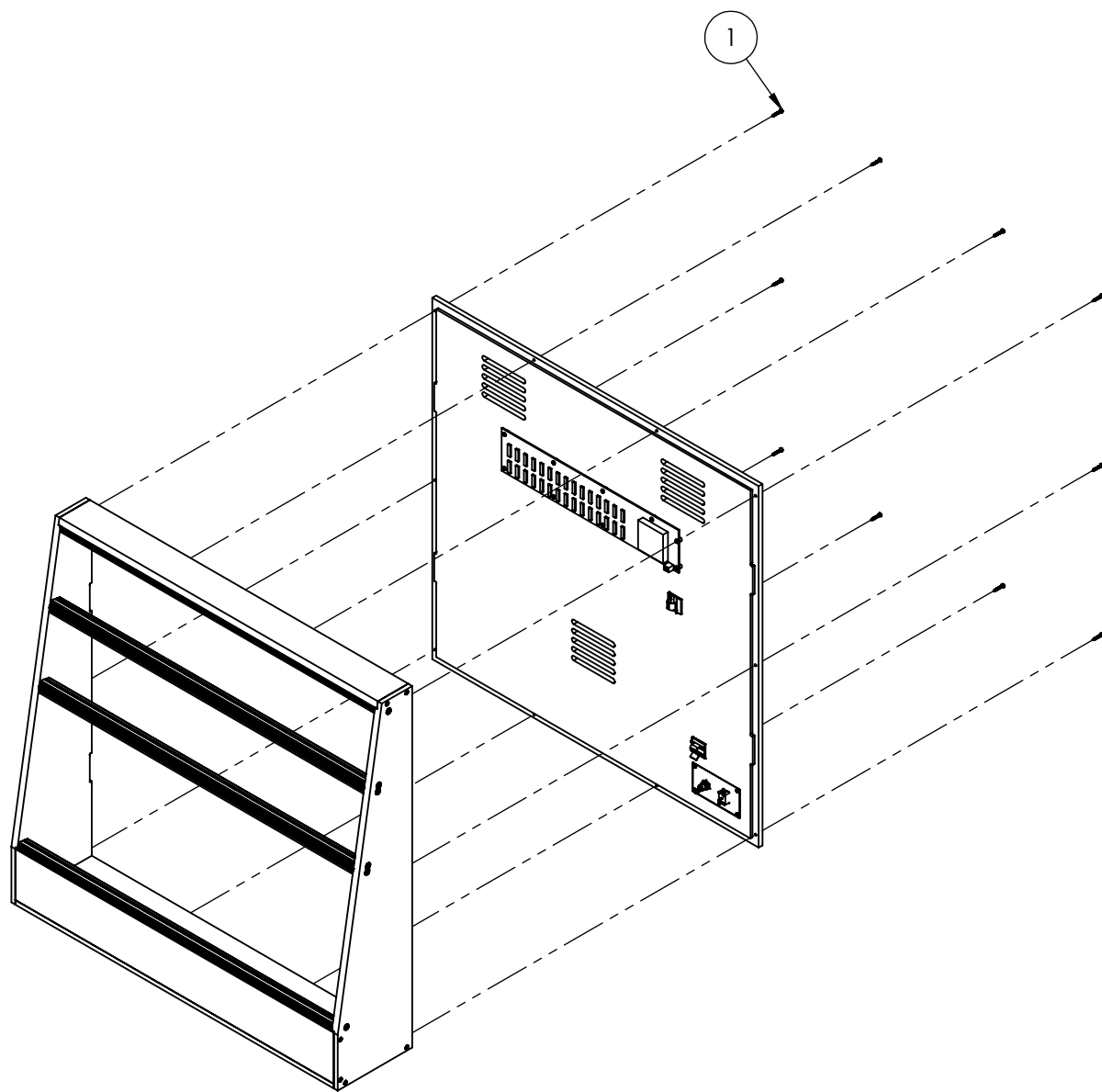

ITEM NO.	PartNo	DESCRIPTION	QTY.
1	002.12.7981.029019	Screw DIN 7981 C 2.9x19	10